

Touch Thermostatic Element

Instruction Manual



WARNING: Read these instructions carefully before using the appliance



COLOR OPTIONS

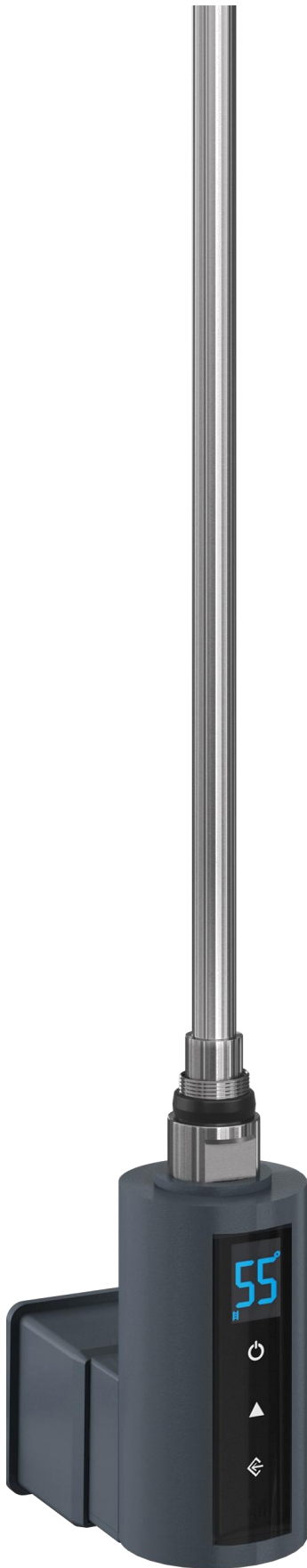

ANTHRACITE



CHROME



WHITE



BLACK

SAFETY INSTRUCTIONS

Please read this instruction carefully before using or installing the heating element.



- Children of less than 3 years should be kept away unless continuously supervised. Children aged from 3 years and less than 8 years shall only be allowed to operate the heater when it has been properly installed and connected. The child must be under adult supervision or have been trained to safely operate the device while understanding the risks.
- Some parts of this product can become very hot and cause burns. Do not touch the surface when in operation. Do not install close to curtains or other combustible materials. Particular attention should be given where children and vulnerable adults are present.
- The element must be installed by a licensed electrician in accordance with current IEE wiring regulations. Ensure that the electrical supply is fully isolated before commencing installation or servicing. The element must be connected to a 220-240 Volt AC mains power supply via a fused spur cable outlet, and must be earthed.
- The element must NEVER be used unless it has been professionally installed inside a towel rail filled with fluid to the correct level. The element will cease functioning if it is not fully submerged in a suitable fluid during operation.
- The recommend quantity of fluid with the towel rail is 90% of the unit's total volume. If you are installing the element in a towel rail that has been pre-filled for use with this element, do not allow fluid to escape when the element is fitted. In the case of loss of heating fluid, contact your supplier.
- Do not use the device if you detect damage to the mains plug or power cable. If the supply cord is damaged, it must be replaced by the manufacturer, its service agent or similarly qualified persons to avoid a hazard. All repairs and servicing must be carried out by a qualified person.
- The towel rail in which the element is installed must be permanently fixed to the wall. Do not fit the towel rail below or in front of an electric socket.
- The element must be placed where the switches and controllers cannot be touched by a person in a bathtub or shower.
- The element must be disconnected from the mains during cleaning and maintenance.
- Never attempt to disconnect the control head from the heating element. The product is an integrated unit that has been factory sealed.
- Do not open the element — any interference with internal components will invalidate the warranty.
- If the towel rail is used to dry clothing or towels, ensure the fabrics have only been washed in water, to prevent the device coming into contact with harsh chemicals.
- The unit is not to be used by persons (including children) with reduced physical, sensory or mental capabilities. Such persons may only use the device if they are supervised by a responsible person.

Warning!

Never tighten using the housing itself, Always use the correct tools (Spanner).

INSTALLATION

- These are general-purpose instructions for fitting your element into a suitable radiator or towel rail. Always check with the radiator manufacturer to ensure the product is suitable for use with the element, and follow any additional installation guidance provided with the unit. Installation must be completed by a qualified electrician. Do not attempt installation DIY.
- **WARNING** – Do not attempt to operate the element before it has been installed in a fluid-filled radiator or towel rail. Switching on the element in an empty radiator or in open air will cause the element to cease functioning. Always switch off the power supply at the mains during installation and maintenance. We recommend that the fuse is withdrawn or circuit breaker switched off at the distribution board while work is in progress.

'Electric-only' Element Installation

- Identify the inlet where the element will be fitted in the radiator or towel rail. For vertical models, the element is fitted vertically, entering at the bottom of the right-hand vertical strut. For horizontal models, the element is fitted horizontally, entering sideways through the lowest horizontal strut. Never fit the element at the top of a radiator or towel rail.
- Tilt the radiator so the next free filling cap is at the highest point. Remove the cap and fill the towel rail or radiator to 90% of its volume with a suitable heating medium. This should be a glycol-based formulation. Replace the cap when done.
- Push the heating element into the radiator (Ensure all threaded joints are wrapped with PTFE tape and the O-ring is present on the element thread)
- Tighten the element at the main nut, using a size 22 spanner. Ensure the rubber O-ring, above the main nut, makes a firm seal between the radiator and the element. This prevents leakage after installation.

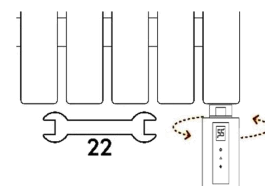

- ◆ **NOTE** - Never attempt to tighten the element by twisting the control head or product housing. Always use the correct tools as directed in the instructions.
- Fit the rail to the wall, following the manufacturers fitting instructions.
- Connect the element to the mains power using a BS fused connection unit.
 - ◆ The wires should be connected as follows: Blue (Neutral), Brown (Live), Green/Yellow (Earth).
- The fused connection unit should be fitted with a 5 Amp fuse to BS1362.
- Shortly after switching on the unit, ensure the towel rail is bled for any excess air.
- Check for leaks and re-tighten joints as necessary.

INSTALLATION

'Dual-fuel' Element Installation

- Identify the inlet where the element will be fitted in the radiator or towel rail. For vertical radiators and towel rails, the element is fitted vertically, entering at the bottom of the right-hand vertical strut. For horizontal models, the element is fitted horizontally, entering sideways through the lowest horizontal strut. Never fit the element at the top of a radiator or towel rail.
- Ensure all threaded joints are wrapped with PTFE tape.
- Ensure the O-ring is present on both the element and Tee piece threads.
- Insert the element into the Tee piece and tighten with a spanner.
- Insert the Tee piece with electric element into the chosen side of towel rail or radiator and tighten with a spanner.
- Fit towel rail or radiator to the wall and connect to the central heating, following the manufacturers fitting instructions.
- Once the rail is mounted on the wall and connected securely to the central heating system, open the radiator valves and allow the rail to fill.
- Once the rail has filled with water, with the central heating OFF, use the air vent to purge any excess from the rail.
- Connect the element to the mains power using a BS fused connection unit.
 - ◆ The wires should be connected as follows: Blue (Neutral), Brown (Live), Green/Yellow (Earth).
- The fused connection unit should be fitted with a 5 Amp fuse to BS1362.
- Shortly after switching on the unit, ensure the towel rail is bled for any excess air.
- Check for leaks and re-tighten joints as necessary.

INSTALL THE CABLE MASK

How to install the cable mask to the element box after installing the element to the towel radiator

Step 1: Slide the decorative cable mask into track on the back of element box

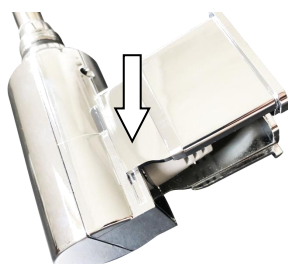

Step 2: Lock the cable to the hole on the mask

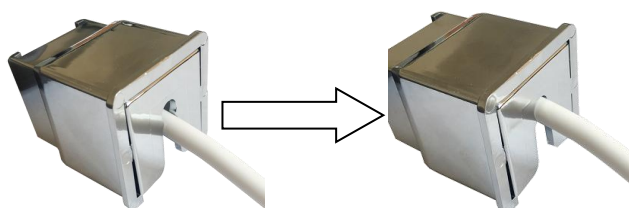

TECHNICAL INFORMATION

Voltage	220-240V AC / 50Hz
Wattage	100-1000W
Temperature setting	30-70 °C (fluid) 15-30 °C (ambient)
Frost Protection	7°C
IP rating	IP44
Timer mode	Boost 2/4 hours
Appliance class	Class I
Thread size	G ½ "
Application	This element is not suitable for dry heating. It must be submerged in liquid (either in a liquid-filled electric-only installation, or as part of a dual-fuel installation).

PANEL DESCRIPTION



OPERATION INSTRUCTION

Standby Mode

Once the thermostatic heater is powered on, the unit will immediately enter standby mode. An arrow signal ▼ will appear on the screen. You can press ⏻ to switch between heating and standby mode.

Antifreeze function: When the heater is in standby mode, it will automatically default to frost protection mode. This means that if the fluid temperature falls below 7°C, the heater will activate and work automatically.

Heating Mode

Press ⏻ to switch the element on. Press ⏸ to switch between modes. The icon on the display will change accordingly, cycling through the following mode: Ambient temperature control mode, Liquid temperature control mode, Boost 2H, Boost 4H.

Ambient temperature control:

In this mode, the element controls the room temperature and heats to a constant set temperature. The external thermostat measures the ambient temperature and instructs the element to heat or stop heating according to the temperature set.

- When the device is in standby mode, press the ⏻ button to switch on then press the button ⏸ to switch modes on the display. While in this mode, a symbol 🏠 will be displayed on the screen.
- Use ▲ to set your desired ambient temperature. The temperature can be adjusted within the range of 15-30°C, with 1°C increments. For example:

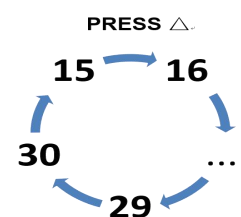

Liquid temperature control:

In this mode, the element controls the towel rail's internal temperature and heats to a constant set temperature. The internal thermostat measures the temperature of the heating fluid and instructs the element to heat or stop heating according to the temperature set.

- Switch on the device then press the button ⏸ to select the liquid temperature control mode. While in this mode, the symbol 📊 will be displayed on the screen.
- Use ▲ to set your desired temperature. There are nine temperature settings available, with a 5°C increment within the range of 30-70°C. For example:

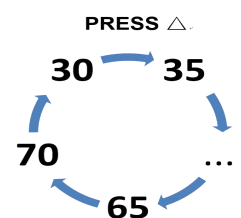

Boost mode:

The device will stay working at the setting hours at maximum performance which is heating the fluid under 70°C. After heating at the setting hours, it will automatically revert back to the previous liquid temperature mode and restore the previous set temperature.

- When the device is in standby mode, press the ⏻ button to switch on, then press the ⏸ button to select and start the boost mode, the screen will display '2H' or '4H' accordingly. For example:

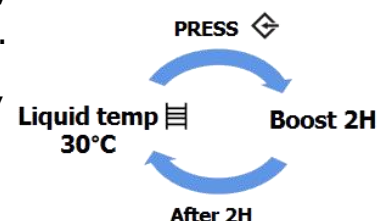

A sun symbol ☀ will flash in the top right corner of the screen, indicating that the unit is actively heating. Once the unit reaches the preset temperature, the sun symbol will disappear and the device will stop heating until the temperature drops.

AUTOMATIC SETTINGS

Over heated protection

If the automatic control system malfunctions, causing the fluid temperature in the radiator to rise uncontrollably, the system incorporates two safety mechanisms to prevent excessive pressure in the radiator. Firstly, the entire system is completely shut down electronically when the fluid temperature reaches 95°C. And if this protective mechanism were to fail for any reason, a simple downstream thermal fuse ensures a complete shutdown, preventing any further heating and potential damage.

Freeze protection

Once the control unit is in "STANDBY" mode (Power on), the control unit has an automatic freeze-protection setting. The default setting for frost protection is between $<7^{\circ}\text{C}$ and 15°C . If the radiator temperature falls below 7°C , the heating system switches on automatically, heats the liquid in the radiator to 15°C and then switches off again. An Ice ❄️ appears on the display. And it will work as a circulation way.

Room temperature compensation

As the NTC that measures the room temperature and provides feedback to the controller is located on the back of the controller, it is in close proximity to the warm radiator. As a result, the measured temperature may not accurately reflect the temperature in other parts of the room. For this reason, there is an automatic temperature adjustment of -3°C in the control unit.

Open window/open door detection

This automatic function detects when the temperature falls by 2°C or more within a short time frame. In this case, the system assumes that this decrease is due to open windows or doors. The control unit will display "OP" and the heating system will be switched off automatically. It will resume heating automatically once the temperature stabilizes.

MAINTENANCE

- Before performing maintenance, always unplug the unit from the mains system.
- Periodically check the fluid level in the towel rail and ensure the heating element is completely submerged.
- Clean the product with a dry or damp cloth. If necessary, use a very small amount of detergent, ensuring that it contains no solvents or abrasives

NOTES PRIOR TO REMOVAL

- Before dismantling permanently, disconnect the heating element from the mains and ensure that the towel rail is not hot.
- Be aware. A towel rail filled with liquid can be very heavy. When moving the towel rail, ensure that you take the necessary safety precautions.
- Before disassembly, close the appropriate valves and drain the towel rail completely to avoid causing any damage.

PRODUCTION DISPOSAL



In accordance with WEEE Directive 2012/19/EU, the icon with the crossed-out waste bin on electrical or electronic equipment stipulates that this equipment must not be disposed of with household waste at the end of its life. You will find collection points for free return of waste electrical and electronic equipment in your vicinity. The addresses can be obtained from your local authority.

The separate collection of waste electrical and electronic equipment enables the re-use, recycling and other forms of recovery of waste equipment, and prevents any negative effects for the environment or human health.